



PRELIMINARY INFORMATION FORM (PIF) for INDIVIDUAL PROPERTIES

Note: PIFs are prepared by applicants and evaluated by DHR staff and the State Review Board based on information known at the time of preparation. Recommendations concerning PIFs are subject to change if new information becomes available.

DHR No. (to be completed by DHR staff) 050-5013

1. General Property Information

Property name: Mt. Sinai Baptist Church

Property address: 2327 Commins Rd.

City or Town: Aylett

Zip code: 23009

Name of the Independent City or County where the property is located: King William

Category of Property (choose only one of the following):

Building ☒ Site ☐ Structure ☐ Object ☐

2. Physical Aspects

Acreage: 2+

Setting (choose only one of the following):

Urban ☐ Suburban ☐ Town ☐ Village ☐ Hamlet ☐ Rural ☒

Briefly describe the property's overall location and setting, including any notable landscape features:

Mount Sinai Baptist Church sits at the southern end of Route 606, Commins Rd.
There is a cementary, parking lot along the southern edge of the building.
The land around the building is cleared and contains a cemetery. A parking lot. Mature trees.
There is a covered pavillion, basketball court, and shed.

3. Architectural Description Gothic Revival

Architectural Style(s): _____

If the property was designed by an architect, landscape architect, engineer, or other professional, please list here: unknown

If the builder is known, please list here: _____

Date of construction (can be approximate): Constructed in 1751 by the government of England for American colonists.

Narrative Description (Please do not exceed one page in describing the property):

Briefly describe the property's general characteristics, such as its current use (and historic use if different), as well as the primary building or structure on the property (such as a house, store, mill, factory, depot, bridge, etc.). Include the materials and method(s) of construction, physical appearance and condition (exterior and interior), and any additions or other major alterations.

Mount Sinai Baptist Church was established in 1751. The church is one story. The cemetery has marked and unmarked graves. There were many additions, revisions and updates throughout the years. The church has a significant African-American history. It was originally called Cattail Church and was one of four Colonial churches in King William County, of which only three exist. Of the three remaining colonial churches, Mangohick, Old St. John, and Mt. Sinai, only Mangohick and Mt. Sinai have African American congregations.

In a bullet list, include any outbuildings or secondary resources or major landscape features (such as barns, sheds, dam and mill pond, storage tanks, scales, railroad spurs, etc.), including their condition and their estimated construction dates.

- Covered picnic/pavillion used for religious social events, and historical
 - church functions such as homecoming, Revival, funeral repast and church Anniversary.
 - During the Pandemic of 2000-2003 was used to conduct church services.
- construction approximately 1990

Basketball court, construction approximately 1990

Cemetery, date of construction 1850 (Antebellum period 1830-1860). This African-American Baptist church cemetery contains burial beginnings from the early 20th century. The earliest grave markers is 1905. Mt. Sinai Baptist continues to inter church families into the 21st century. The cemetery covers area and there are numerous early unmarked graves.

Shed. construction approximately 1940

4. Property's History and Significance (Please do not exceed one page)

Briefly explain the property's historic importance, such as significant events, persons, and/or families associated with the property.

If the property is important for its architecture, engineering, landscape architecture, or other aspects of design, please include a brief explanation of this aspect.

See Attached

Please list all sources of information used to research the history of the property, such as deeds, census and tax records, and/or published articles and books. (It is not necessary to attach lengthy articles or family genealogies to this form.)

-
- Church book which logs history, County assesment records and 2007 survey conducted by VA Dept. of Historic Resources
-

5. Property Ownership (Check as many categories as apply):

Private: ☒ Public\Local ☐ Public\State ☐ Public\Federal ☐

Current Legal Owner(s) of the Property (If the property has more than one owner, please list each below or on an additional sheet.)

name/title: Mount Sinai Baptist Church

organization: Mount Sinai Baptist Church

street & number: 2327 Commins Road

city or town: Aylett state: VA zip code: 23009

e-mail: _____ telephone: 804-769-4879

☒ Legal Owner's Signature: [Signature] Trustee
Date: 17 Mar 2025

• • Signature required for processing all applications. • •

In the event of corporate ownership you must provide the name and title of the appropriate contact person.

Contact person: _____

Daytime Telephone: _____

Applicant Information (Individual completing form if other than legal owner of property)

name/title: Rev. Dr. Maria Harris, Associate Minister

organization: Mt. Sinai Baptist Churh

street & number: 1796 East River Rd.

city or town: King William state: VA zip code: 23086

e-mail: thg1950@gmail.com telephone: 804-769-9489

Date: _____

PLEASE DO NOT ATTACH CONTINUATION SHEETS TO THIS FORM. THANK YOU!

ATTACHMENT

Properties, History and significance.

Cattail Baptist Church was constructed in 1751 by the government of England for American colonist. In 1751, white church Cattails, turn overed the property to the black community and it was used as a school and church in 1869. Sampson dedicated the church in 6/13/1869.

History Dates of Pastors and significant accomplishments:

6/13/1869 – 1874, Rev. Thomas Sampson,

Rev. Sampson dedicated the church in 6/13/1869.

1874-1905, Rev. Silas Miles

First choir established 1903

1905-1945, Rev. Samuel B. Holmes,

First trustee board established in 1906

Mt. Sinai Baptist Church, trustee board secured the deed from the St. Davis Episcopal Church in 1917

The Women Workers club purchased pump organ in 1908, Alberta Owens first organist.

The vestibule was built in 1921

Carbon lights were installed in 1937.

Choirs purchased robes in 1940.

1946-1979, Rev. E. Moore,

1946 electricity installed and lights.

1947 new pulpit was purchased, new pews and ceiling fan remolded.

1950-51 the choir loft was placed behind the pulpit,

1950 the deaconess board was created.

1950 the first clerk was created, Washington Henry

1950 first deacon board was created, Henry Hill, Ottaway Chamberlain, William Moore

1950 the first treasurer created, James Nelson

1960 central heating system was installed

1965 baptism pool put in under pulpit.

1966 add on: Pastor study, kitchen, bathroom, multi purpose room, choir room,

1975 new pews installed.

1979-1986, Rev. E. Warren

1979 received 2 acres of land, air condition unit.

1987-1989, Rev. Thurman Williams

1989 storm windows installed

1990-2005, Rev. Dr. Gene Quarles

1994 pavilion constructed outside, front stoop and steps refurbished,

1998 handicap ramp constructed, new carpet, new fellow ship hall, black top and basketball court.

2004 church steeple was remodeled.

2006 Rev. Adkins

- Rev. Robert Wormley
- Rev. Dabney
- Rev. Dr. John Boyd

2016-Present, Rev. Dr, Charlene Gresham

Baptized 5 youths and 1 adult

Licensed first Associate Minister in 2019 ----Rev. Dr. Maria Harris

Added 1 trustees, 1 usher, 1 deacon, and Minister of Music

Bestow honorary Doctor of Music degree to Tony Hobbs

Choir was reestablished.

Sunday school was reestablished

Bible study was reestablished

A youth ministry was established

Back to school drive was established

Actively participated Pamunkey Baptist Association.

Establish an effective communication system through Facebook, teleconference and zoom. That enabled persons within the Church to know what's going on and be able to communicate with Pastor and leadership.

2000-2003 Pandemic; Created Sunday service on Zoom and Facebook, and held outside church services in the pavilion.

Reestablished former important historical Church events such as: Homecoming and Revival, Church Anniversary, Usher Day and Friend and Family Day

Established Church logo and letterhead.

Installed roofing, air conditioning and security cameras.

Conducted various fundraising events that paid off: new roofing, air conditioning/ heating. and security cameras.

2327 Commins Road

Location 2327 Commins Road

Mblu 21 / 59 /

Acct# 7162

Owner CATTAIL CHURCH

PBN Religious

Assessment \$252,900

PID 8734

Building Count 1

Current Value

Assessment					
Valuation Year	Building	Extra Features	Outbuildings	Land	Total
2023	\$203,100	\$0	\$9,800	\$40,000	\$252,900

Owner of Record

Owner CATTAIL CHURCH
Co-Owner
Address PO BOX 156
AYLETT, VA 23009

Sale Price \$0
Certificate
Book & Page 0/0
Sale Date 10/06/2020
Instrument 00

Ownership History

Ownership History						
Owner	Sale Price	Certificate	Book & Page	Instrument	Sale Date	Ref Number
CATTAIL CHURCH	\$0		0/0	00	10/06/2020	000000000

Building Information

Building 1 : Section 1

Year Built: 1751

Living Area: 3,659

Building Attributes	
Field	Description
Model	Commercial
Style	Churches
Grade	Grade C

Building Photo

 Building Photo

(<https://images.vgsi.com/photos/kingwilliam2023VAPhotos/AProperty%201r59~2022.06.17-09.14.02.19.jpg>)

Stories	1
# Units	
Roof Type 1	Typical
Roof Type 2	
Roof Cover 1	Metal
Roof Cover 2	
Roof Cover 3	
Exterior Wall 1	Stucco
Exterior Wall 2	Cinder Block
Exterior Wall 3	
Frame Type 1	Wood Frame
Frame Type 2	
Heat System	Other
Heat Fuel 1	Typical
Heat Fuel 2	
Heat Fuel 3	
AC Type	None
Interior Wall 1	
Interior Wall 2	
Interior Wall 3	
Interior Floor 1	
Interior Floor 2	
Interior Floor 3	
Interior Floor 4	
Wall Height	
Primary Bldg Use	Religious - Comm
Total Room(s)	
Bedroom(s)	
Full Bath(s)	
Half Bath(s)	
Extra Fixture(s)	
Extra Kitchen(s)	
Fireplace(s)	
Chimney(s)	
Foundation 1	Cinder Block
Foundation 2	Crawl Space
Foundation 3	
Foundation 4	
Basement	
Fin Bsmt Area	
# Mobile Homes	

Building Layout

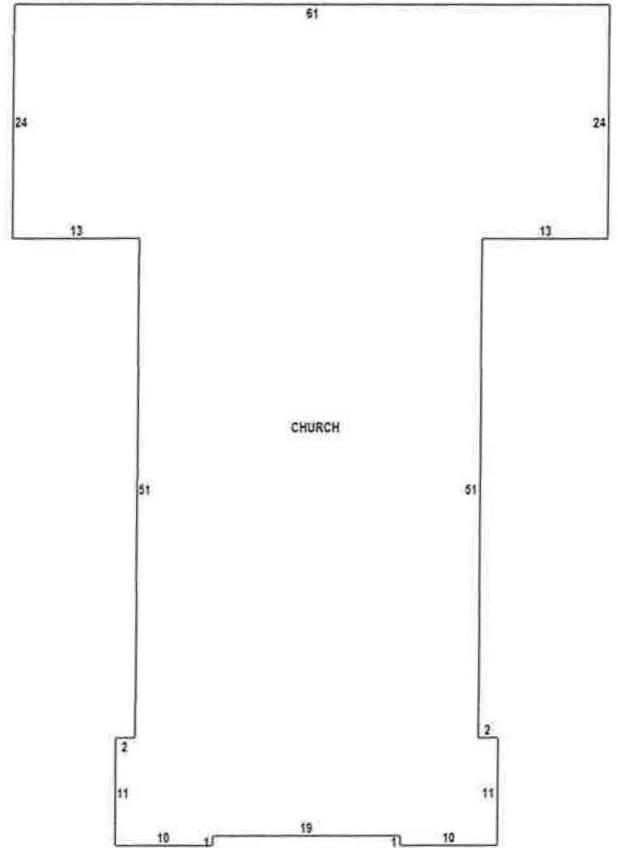

(ParcelSketch.aspx?pid=8734&bid=8734)

Building Sub-Areas (sq ft)			Legend
Code	Description	Gross Area	Living Area
CHURCH	Church	3,659	3,659
		3,659	3,659

MH Type	
Central Heat	No
Central Air	No

Extra Features

Extra Features	Legend
No Data for Extra Features	

Parcel Information

Use Code 760C
Description Religious - Comm
Deeded Acres 1

Land

Land Use

Use Code 760C
Description Religious - Comm
Zone
Neighborhood P
Alt Land Appr No
Category

Land Line Valuation

Size (Acres) 1
Frontage 0
Depth 0

Outbuildings

Outbuildings						Legend
Code	Description	Sub Code	Sub Description	Size	Assessed Value	Bldg #
PICNIC	Picnic Shelter			960.00 UNITS	\$9,600	1
SHED	Shed	NCV	No Value	0.00 UNITS	\$200	1

PIF BOUNDARY MAP

Mount Sinai Baptist Church
King William County, VA
DHR ID# 050-5013

 Proposed Boundary

0 100 200 300
 Feet























MT. SINAI BAPTIST CHURCH



EST. 1751







































































